

**ITEM 10. MOBILE CRANE – TEMPORARY ROAD CLOSURES – PITT  
STREET SYDNEY**

**TRIM RECORD NO: 2014/508966**

**RECOMMENDATION**

It is recommended that the Committee endorse the temporary road closure of Pitt Street, between Hunter and King Streets, Sydney, on Sunday 1 February 2015 from 5am to 10pm, subject to the following conditions:

- (A) The Applicant must comply with the temporary road closure conditions as mentioned in Schedule C of this Agenda.
- (B) The Applicant must comply with any other conditions imposed by City's Construction Regulation Unit.
- (C) The Applicant has indicated the Sunday 8 February 2015 as an alternative date for the above work as a contingency for inclement weather.
- (D) The Applicant must contact the Sydney City Police to obtain a separate police permit and to discuss deployment of user pay police for the road closure.
- (E) The Applicant is to obtain a Road Occupancy Licence from the Transport Management Centre prior to commencement of works.
- (F) If the above closure dates conflict with any future Light Rail or other works, they may be changed to new dates in consultation with Transport Management Centre and Sydney City Police.
- (G) The Applicant must contact Westin Hotel and establish an access arrangement for their patrons during the closure to the satisfaction of the City.
- (H) The Applicant must provide a telephone number of the supervisor responsible for the proposed closure and include contact details in the notification letters to be distributed to affected stakeholders.

**DECISION**

**BACKGROUND**

Marr Contracting Pty Ltd has applied for the temporary road closure of Pitt Street, between Hunter and King Streets, Sydney, on Sunday 1 February 2015 from 5am to 10pm.

**COMMENTS**

The proposed temporary road closure is required to allow a mobile crane to be used to remove a tower crane on the frontage of 120 Pitt Street.

The Applicant has provided a site-specific Traffic Control Plan that includes details of barricades, signs, flagmen and other traffic devices to implement the proposed road closure.

The proposed road closure may coincide with scheduled closures associated with early works for the CBD and South Eastern Light Rail. As such, the Applicant must liaise, and obtain approval from the CBD Taskforce through the Transport Management Centre's Road Occupancy Licence process for the temporary road closure.

The temporary road closure will not affect any other properties, as local access will be provided at all times and alternative access routes are available nearby.

### **CONSULTATION**

The Applicant will be required to notify affected stakeholders as stipulated in Schedule C.

### **FINANCIAL**

All costs associated with the proposed closure will be borne by the Applicant.

### **ATTACHMENTS**

Mobile Crane – Temporary Road Closures – Pitt Street Sydney



Ajay Nayyar, Traffic Works Coordinator

NOTES:  
 ALL TRAFFIC CONTROL PLANS ARE COPYRIGHT & THE  
 PROPERTY OF ADAMS TRAFFIC MANAGEMENT PTY LTD AND  
 ARE NOT TRANSFERABLE UNLESS AUTHORISED BY ADAMS  
 TRAFFIC MANAGEMENT PTY LTD

① ALL TRAFFIC IN ANGEL PLACE TO  
 TRAVEL N/B UNDER POLICE CONTROL

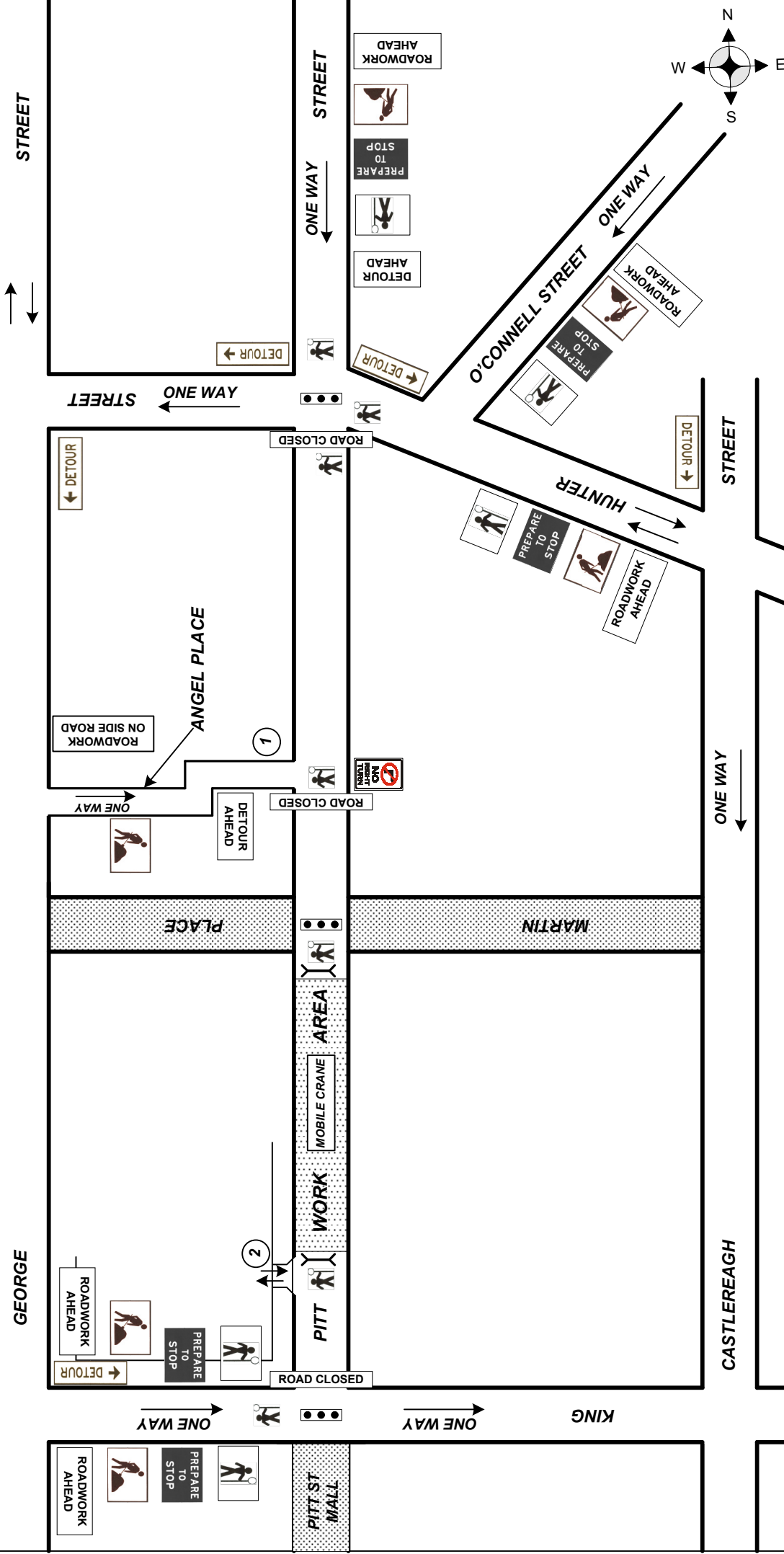
② ACCESS TO THE WESTERN CAR  
 PARK TO BE MAINTAINED UNDER  
 POLICE CONTROL

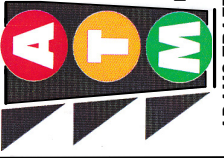

<b>Client:</b> <b>MARR CONTRACTING</b>	<b>Loc:</b> <b>PITT STREET SYDNEY</b>		<b>Ph: 9899 3307</b> <b>Fax: 9899 3304</b> <b>Mob: 0415 475 742</b> Email: david@adamstraffic.com.au	<b>ADAMS TRAFFIC MANAGEMENT PTY LTD</b>	<b>Approach Speeds=up to 50KM</b> Day/Night - Class 1 Signs to be used All Personnel to wear Hi Vis Clothing Cone Spacing 5M in Taper Cone Spacing 10M in Delineation Vehicles to park within the worksite RTA certified Traffic Controllers to be employed	<b>NOTE: This traffic control plan is drawn to AS 1742.3 and the RTA worksite manual for traffic control at work sites and is to be implemented as such. This TCP can be altered on site, &amp; must be dated &amp; signed by an RTA accredited person, who then becomes responsible for the implementation of the changed TCP.</b>	Drawn by: E.P. Geeser	Signed by: 	Date: <b>2/12/14</b>
							RMS No: 2243016735		
					<b>NOT TO SCALE</b>				

